

Safeguarding Information for Volunteers and Visitors

Safeguarding Statement

We are committed to safeguarding and as a visitor to Withycombe Raleigh Primary School it is vital that you are aware of our safeguarding procedures. Everyone who works at this school has a responsibility to ensure that all of our pupils are safe. We expect visitors to do the same.

Procedures

Signing in and out

All visitors to the school must sign in on arrival and out on departure, and wear a visitors badge throughout the visit.

What should I do if I am worried about a pupil?

If you are worried about the safety or wellbeing of any child in our school, please report this to Reception who will pass your concern to the DSL.

Mobile Phones

Visitors should not photograph or film pupils.

Visitors must switch off mobile devices whilst on school premises. If you wish to make a phone call, please return to the main entrance.

Please ask a member of staff if you are unsure of any of the points on this information sheet.

Our Safeguarding Policy can be found on our school website or a paper copy can be obtained from the DSL.



Safeguarding Contacts

Designated Safeguarding Lead (DSL)

Emma Jones (Deputy Headteacher)

Deputy Designated Safeguarding Lead (DDSL)

Kathryn Lee (Assistant Headteacher)

Governors with Safeguarding responsibility

Mrs Sue Humphries, Mrs Alison Cooper

Amphitheatre

Community Room



Orcombe Building Second Floor

School Field

Nurture Room



Raleigh House



Main Playground

St Michael's House



Covered Walkway

Main Playground



Withycombe House

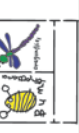

Foundation Outdoor Play Area

Front gate

School Lane Gate

School Hall

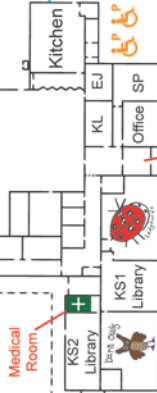

Front Car Park Visitor Parking by prior arrangement only

Reception

Main entrance

Rear Staff Car Park



Withycombe Raleigh Primary School
 Withycombe Village Road
 Exmouth
 EX8 3BA
 Tel: 01395 263397